

PROLED FLEX STRIP OPAL SHAPE L6OP7xx / L6OP8xx

Characteristics:

- SMD CHIP MONO (neutral white, warm white, super warm white).
- Power supply 24 VDC (L6OP7xx) or 48 VDC (L6OP8xx).
- Homogenous light. No single points visible.
- Safety class IP65. Suitable for wet room and covered outside.
- Operating temperature range -10° C till +45° C.
- CE compliant with applicable European directives.
- This product contains a light source of energy efficiency class F.

Warning:

1. For covered outside use possible.
2. Please ensure that the packaging is disposed of in a safe environment.
3. We do recommend that a qualified electrician should be used to install the products.
4. Do not look at the lighted lamp directly.
5. Please watch out at installation for thermal expansion or shrinking.

Safety indices:

Be sure to have a qualified electrician complete installation. The customer is not entitled to claim for any lights installed without observing European safety directives. The manufacturer is then discharged from liability when damage is caused by improper use or installation. For indoor use only. Protection class IP65.

Preinstallation:

Please follow the sequence of installation step by step. Non-observance can lead to damage of the flex strip.

1. Switch off the electricity at the mains before commencing installation or lamp change and (if a fuse box is installed) remove the appropriate circuit fuse to avoid accidental switching on of the mains supply.
2. Connect the flex strip to the power supply 24 VDC or 48 VDC output (secondary side).
3. Connect connector (primary side) of power supply to mains (220-240VAC).
4. If a dimmer is used, than it must be placed between power supply and the flex strip.

Installation possibilities:

1. Please keep in mind, that following strain is not allowed:



DO NOT PRESS

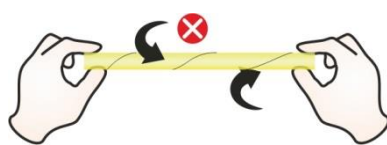

DO NOT TWIST



DO NOT STRETCH

2. Minimum bending diameter at FLEX STRIP OPAL SHAPE

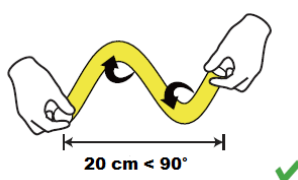
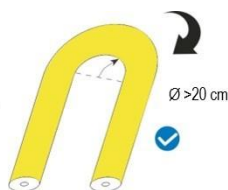

Installation:

1. Please take care about following points before installation

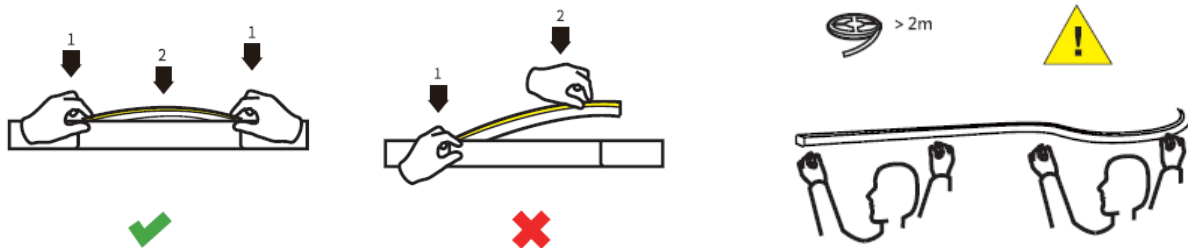

Installation only from both sides allowed.
Do not install from one side

At length over 2m only 2 person
for installation allowed.

2. Please take care about following points before deinstallation



Please be carefull at deinstallation. Do not pull at light

At length over 2m only 2 person
for deinstallation allowed.

3. Connection diagramm

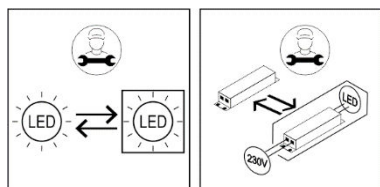
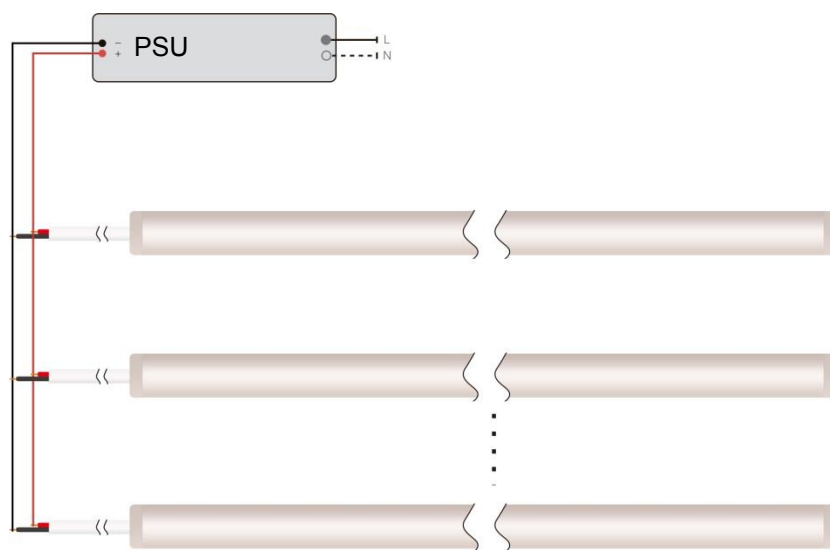

Installation and commissioning may only be performed by qualified persons.
National installation regulations must be observed.
Luminaires must be disconnected from mains before any work.

4. Replacement of the included light source

Principle, the built-in light source can be replaced by a trained electrician without permanent damage to the containing product. Generally available tools are sufficient.

Installation for vertical hanging:

- Following items are needed for a vertical installation:
L6OP7A03 (1m) or L6OP7A03S (1m) or L6OPA04 (2,5m) or L6OPA04S (2,5m)

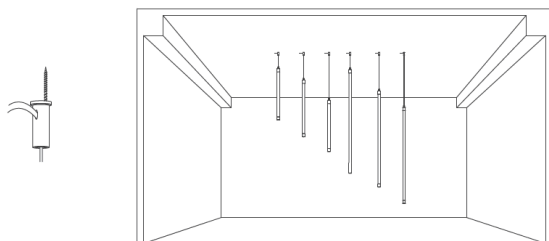

side input / concrete ceiling

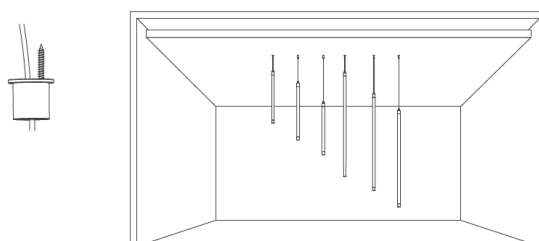

vertical input / suspended ceiling

2. Installation steps

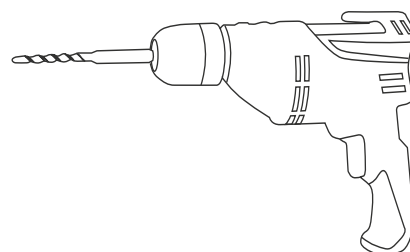

Mount together end cap, plug
Cable length is 2m

Drilling machine with drill Ø6 mm

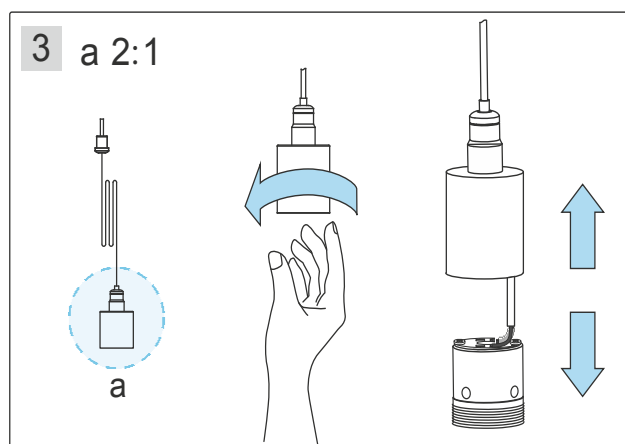
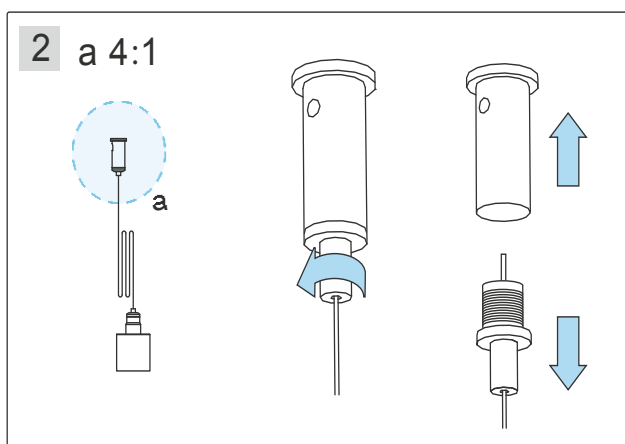
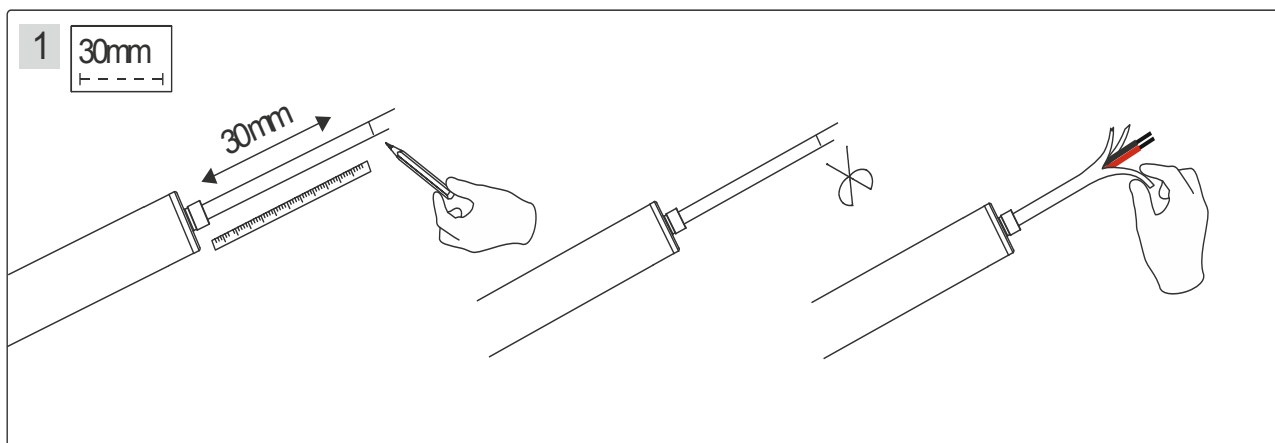

4 a 4:1

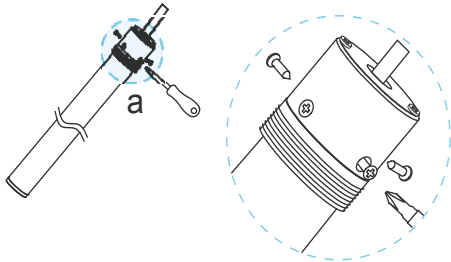

5 a 4:1

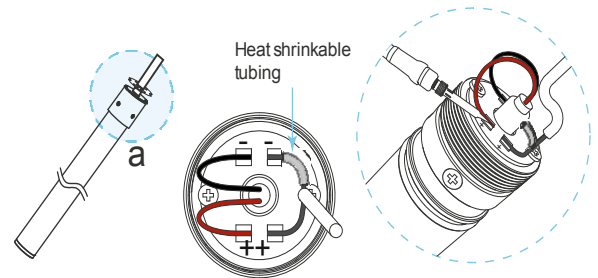

6

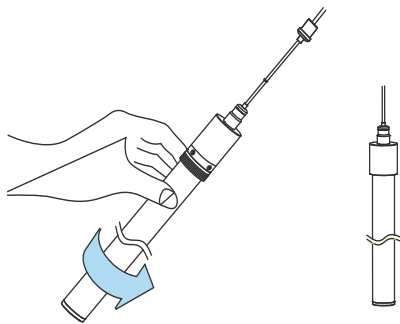

7

L

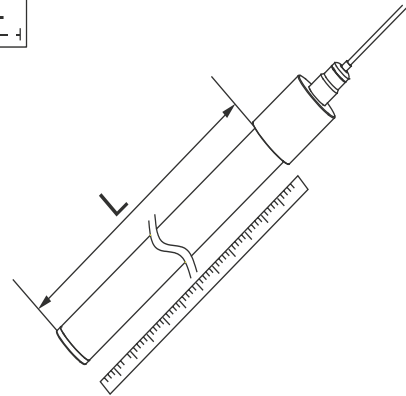

8

L-22mm

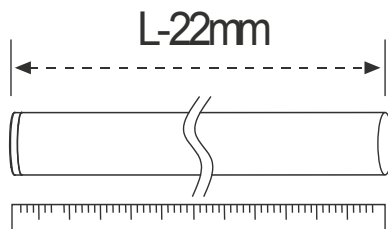

9

L-22mm

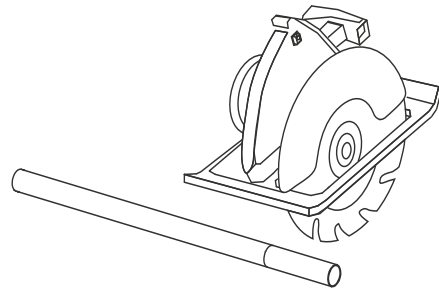

PC-pipe must be 22mm shorter than the Flex Strip OPAL

10

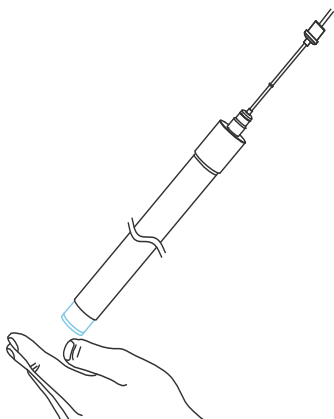

11

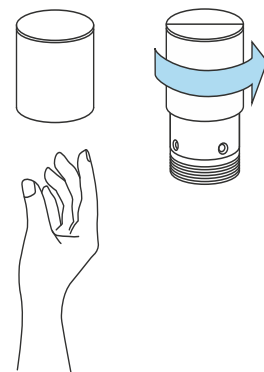

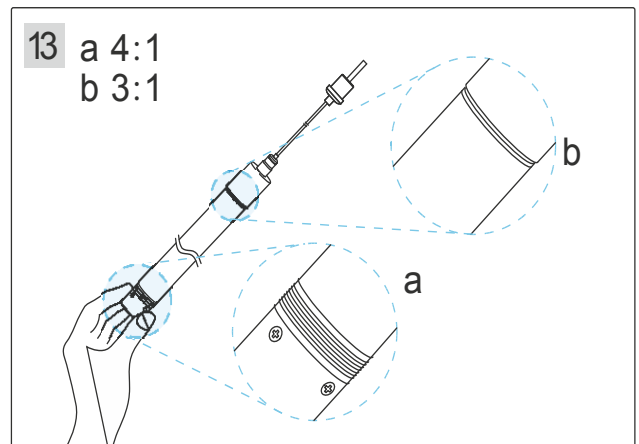
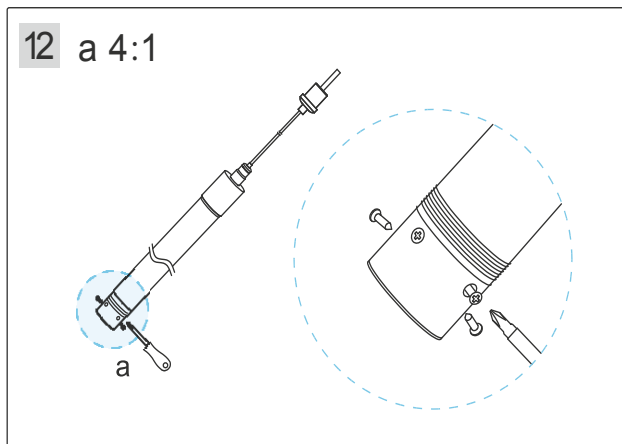

Pull the O-ring in the end cap of the PC-pipe

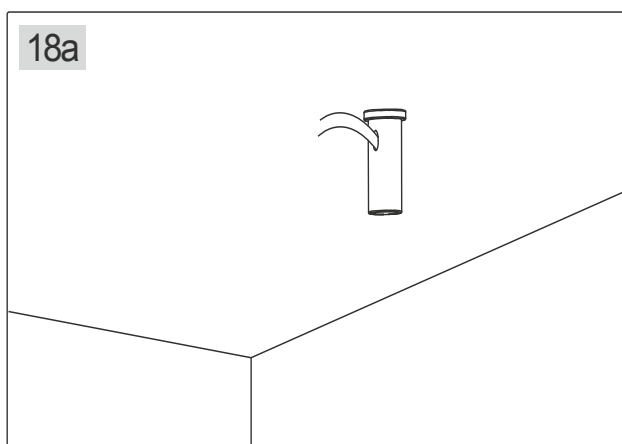
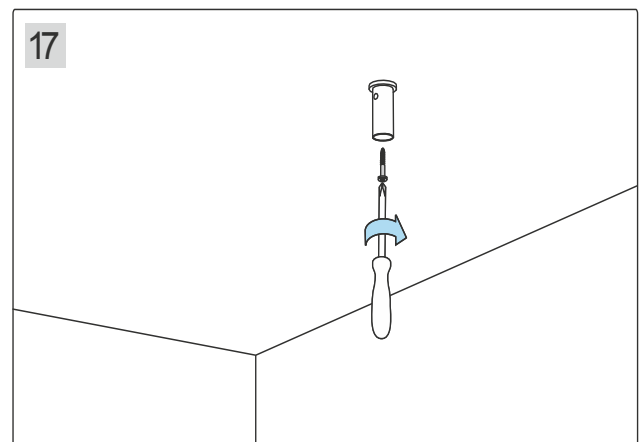
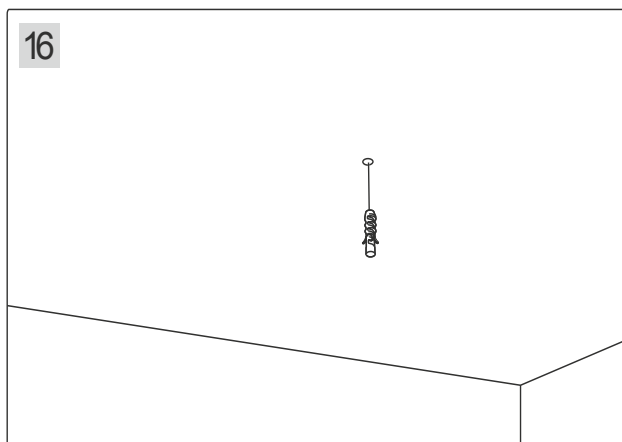
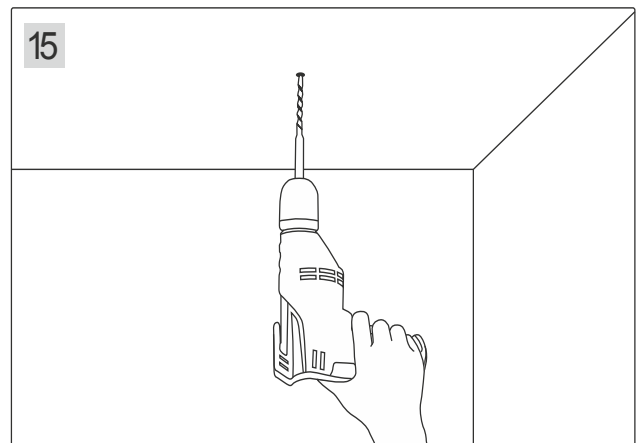
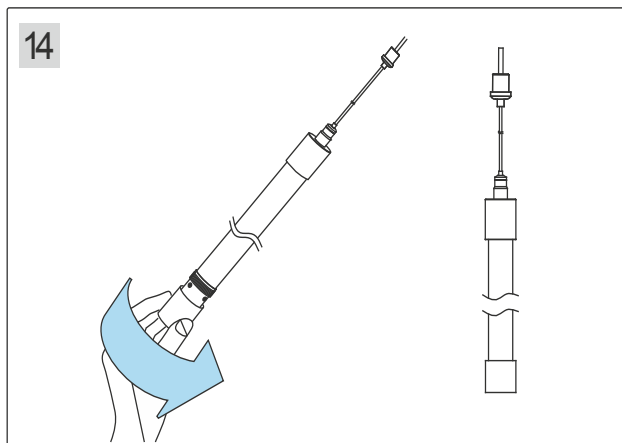

Concrete ceiling, side input

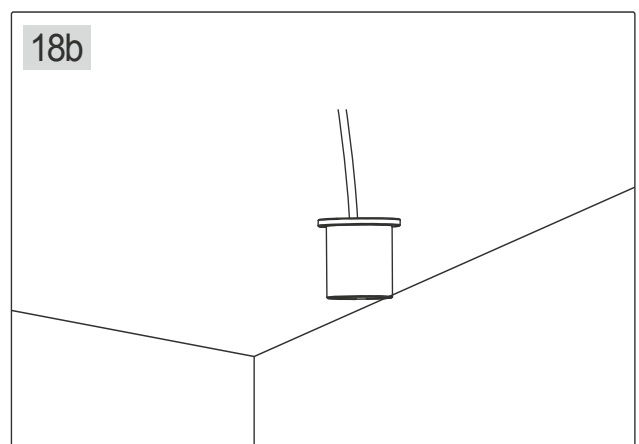

Suspended ceiling, straight input

19



20

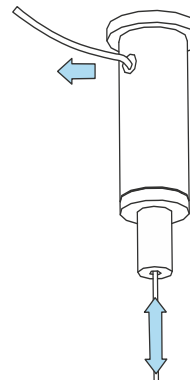

21

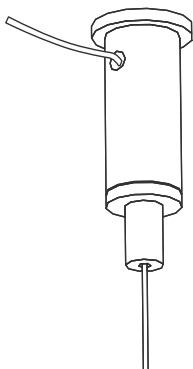

✓

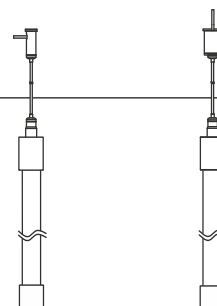

Installation for bended arrangement:

1. Following item is needed for a bended installation:
L6OP7A13

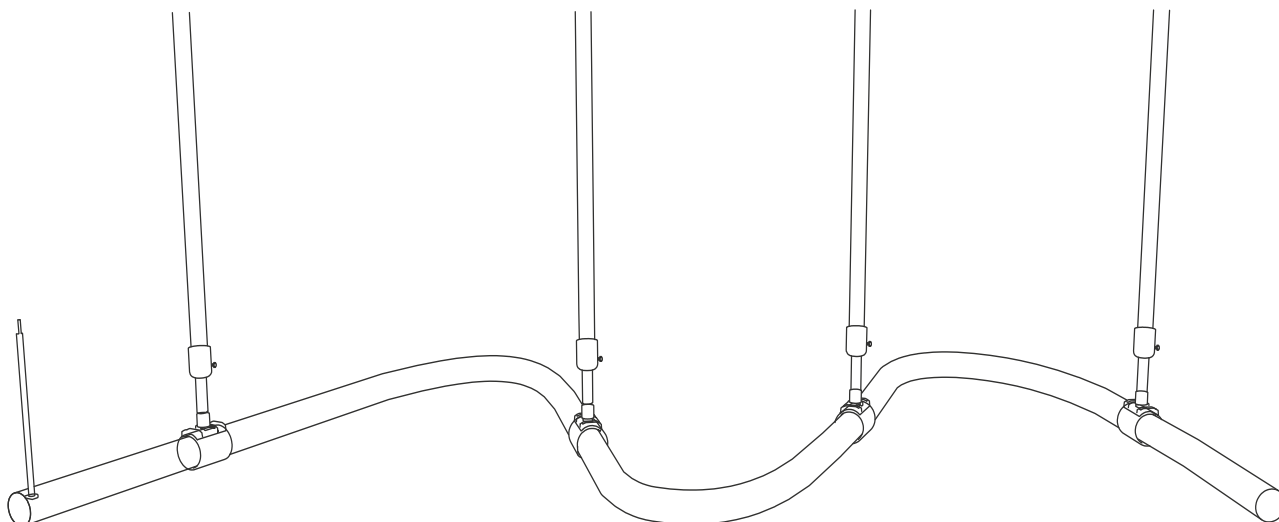

2. Installation steps

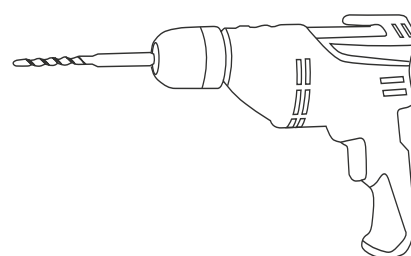
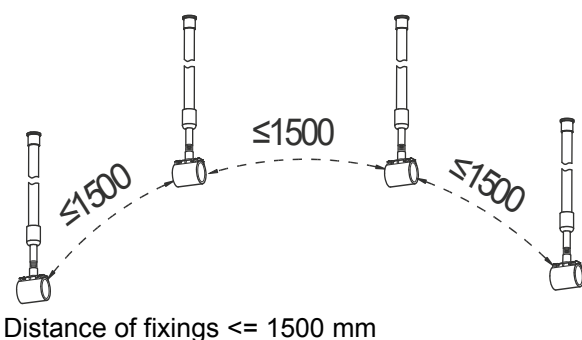
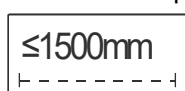

Drilling machine with drill Ø6 mm

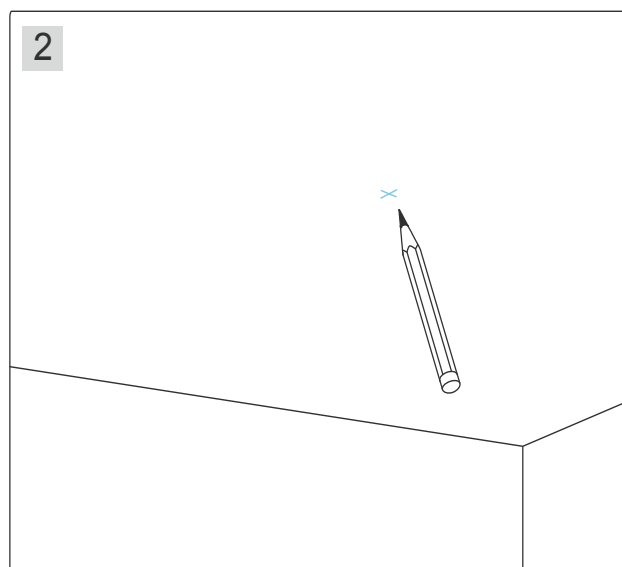
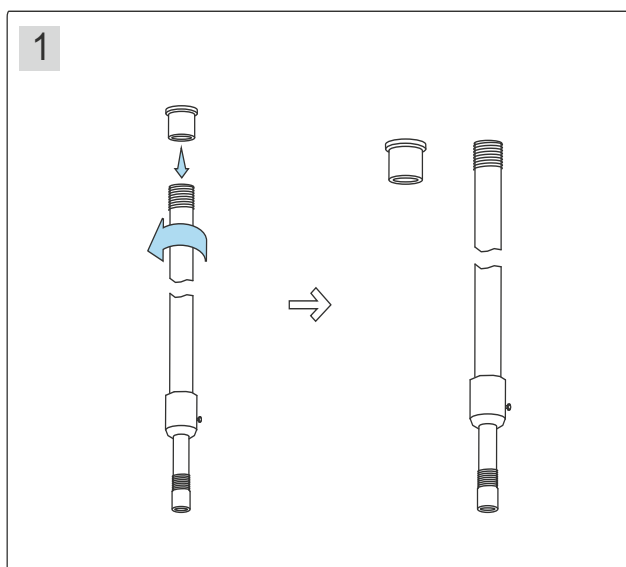

ATTENTION: To prevent a possible hanging, depending on the shape, we suggest to use supports every 500 mm.

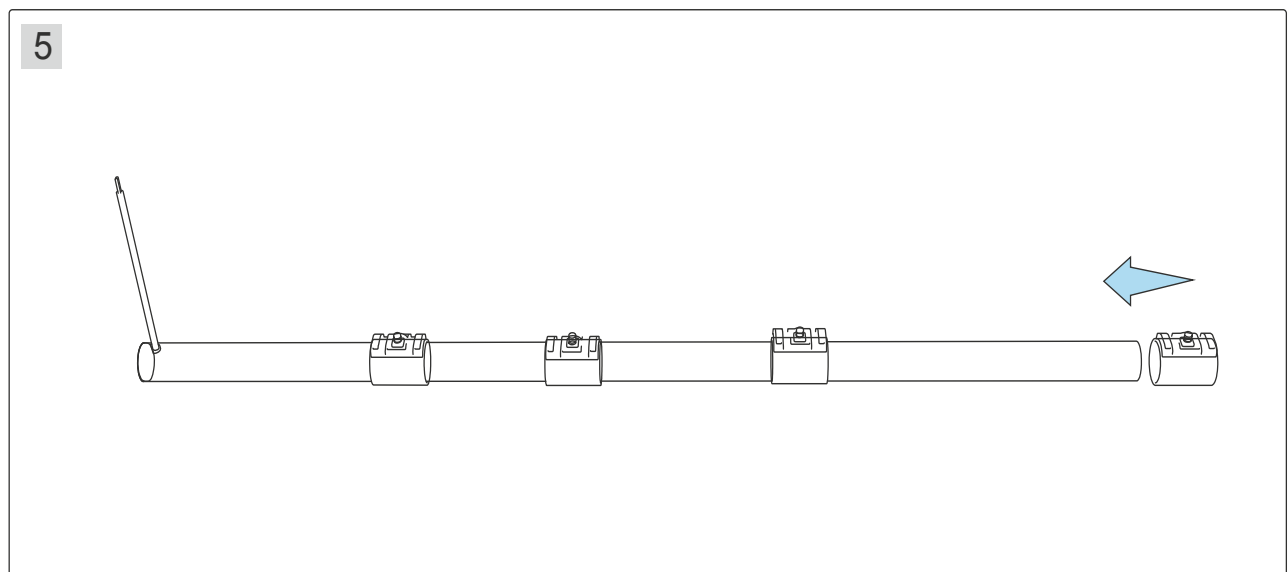
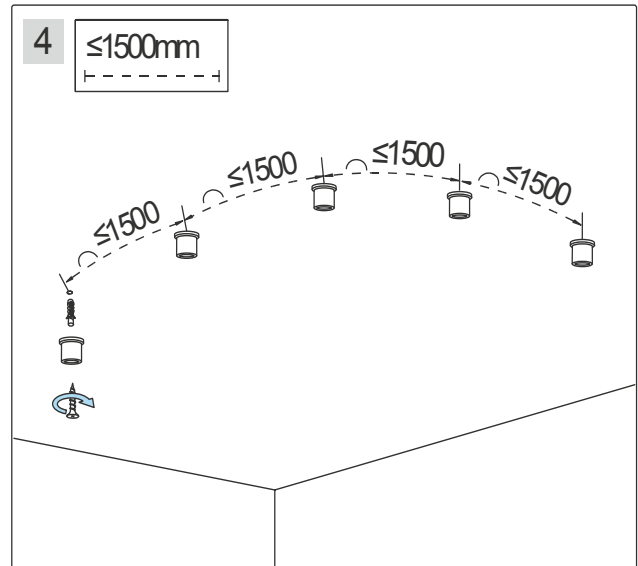
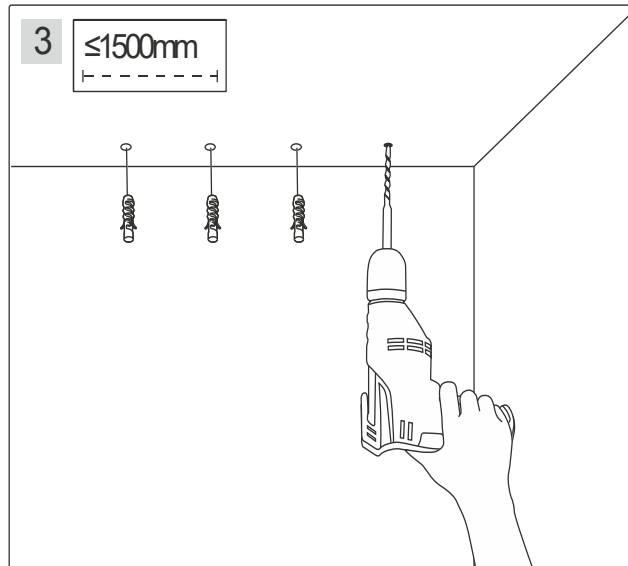

Put the fixings on the Flex Strip OPAL.

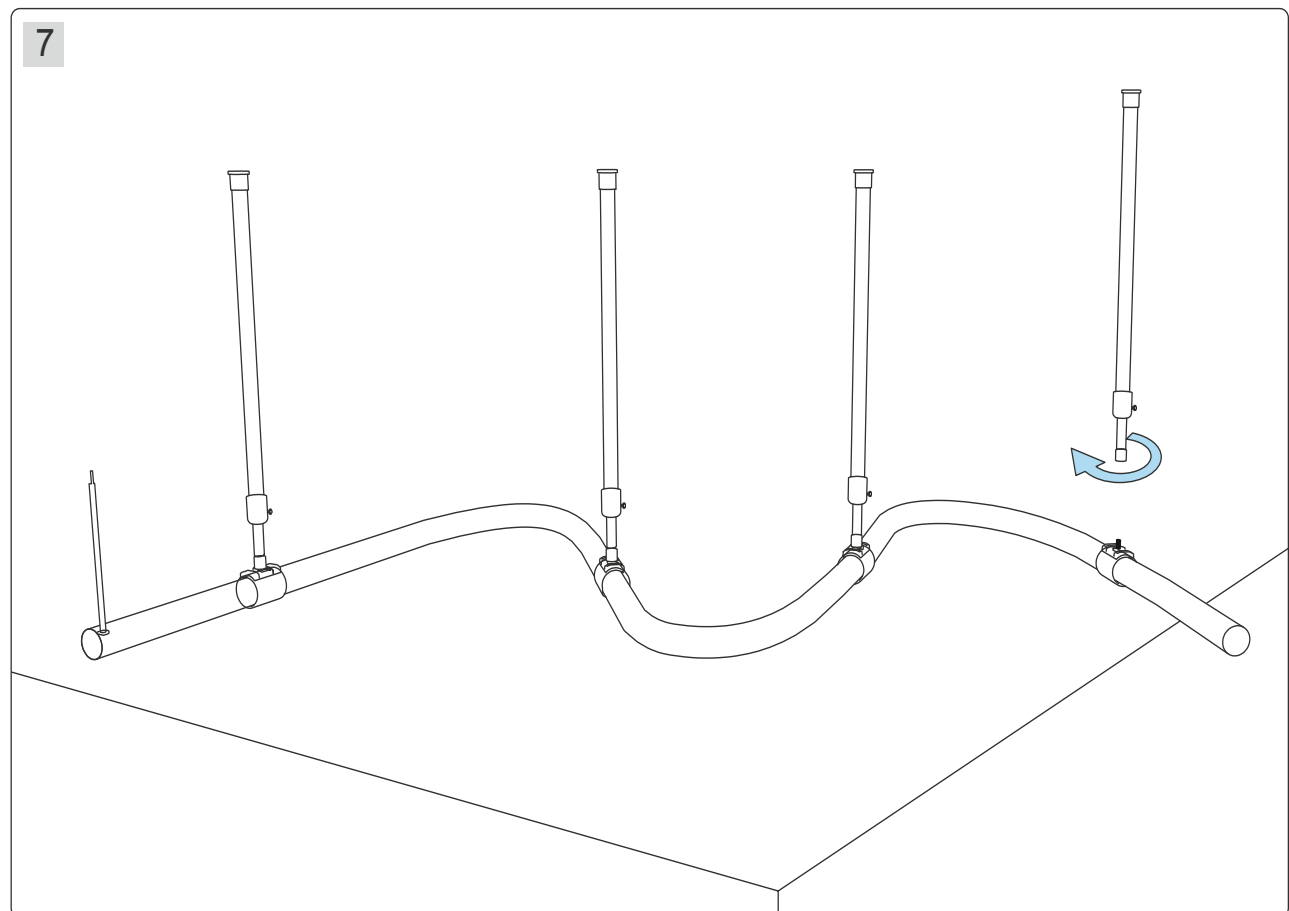
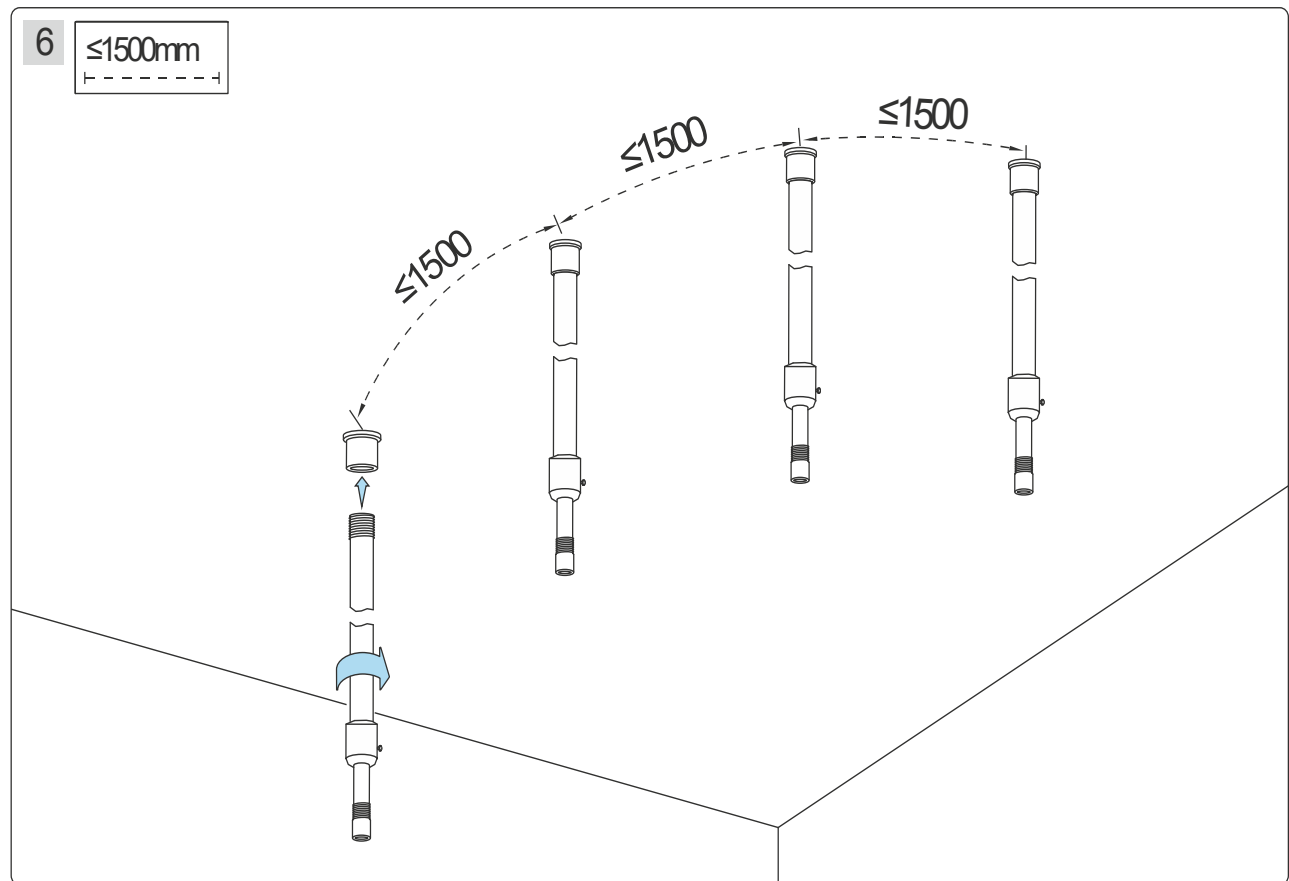

8 a 4:1

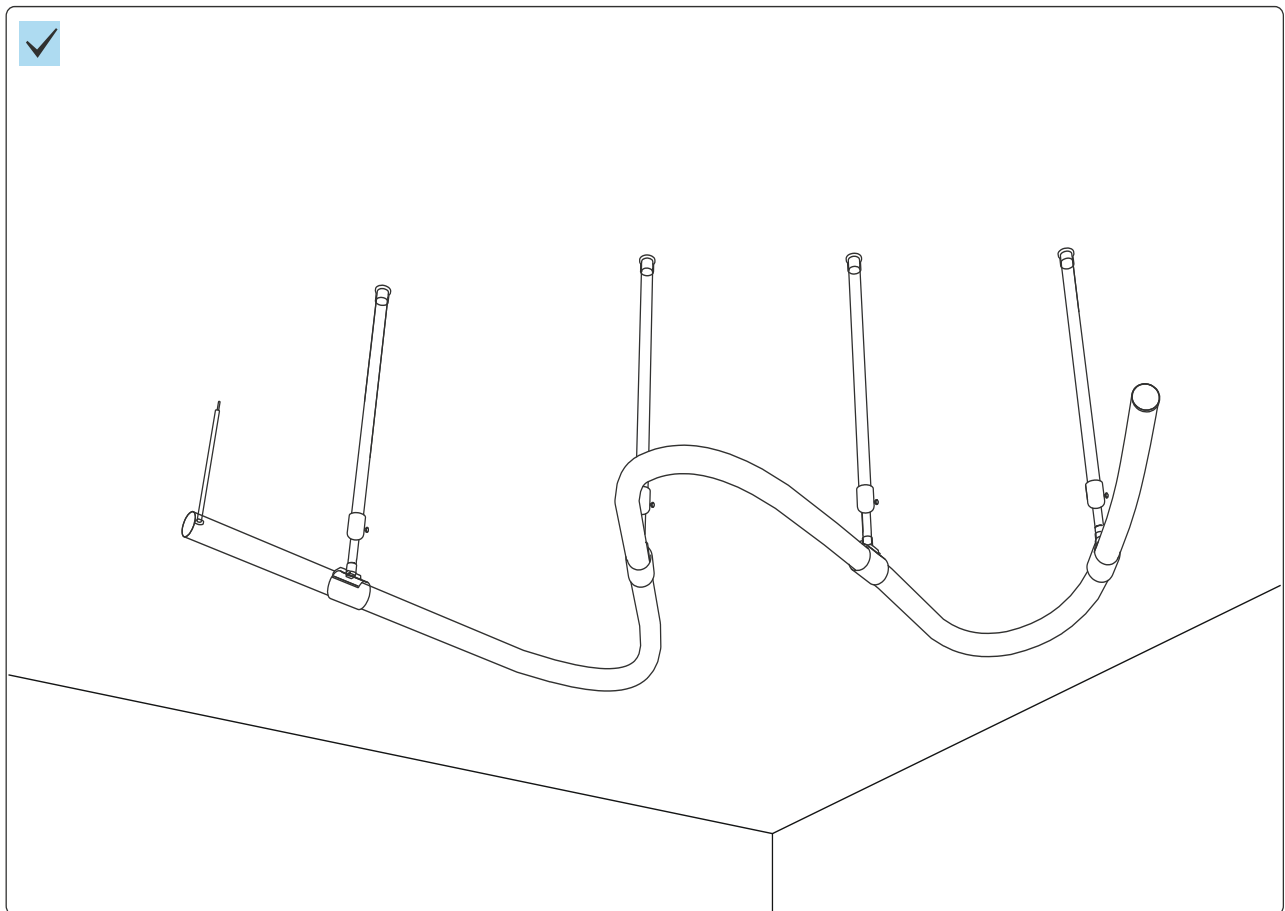
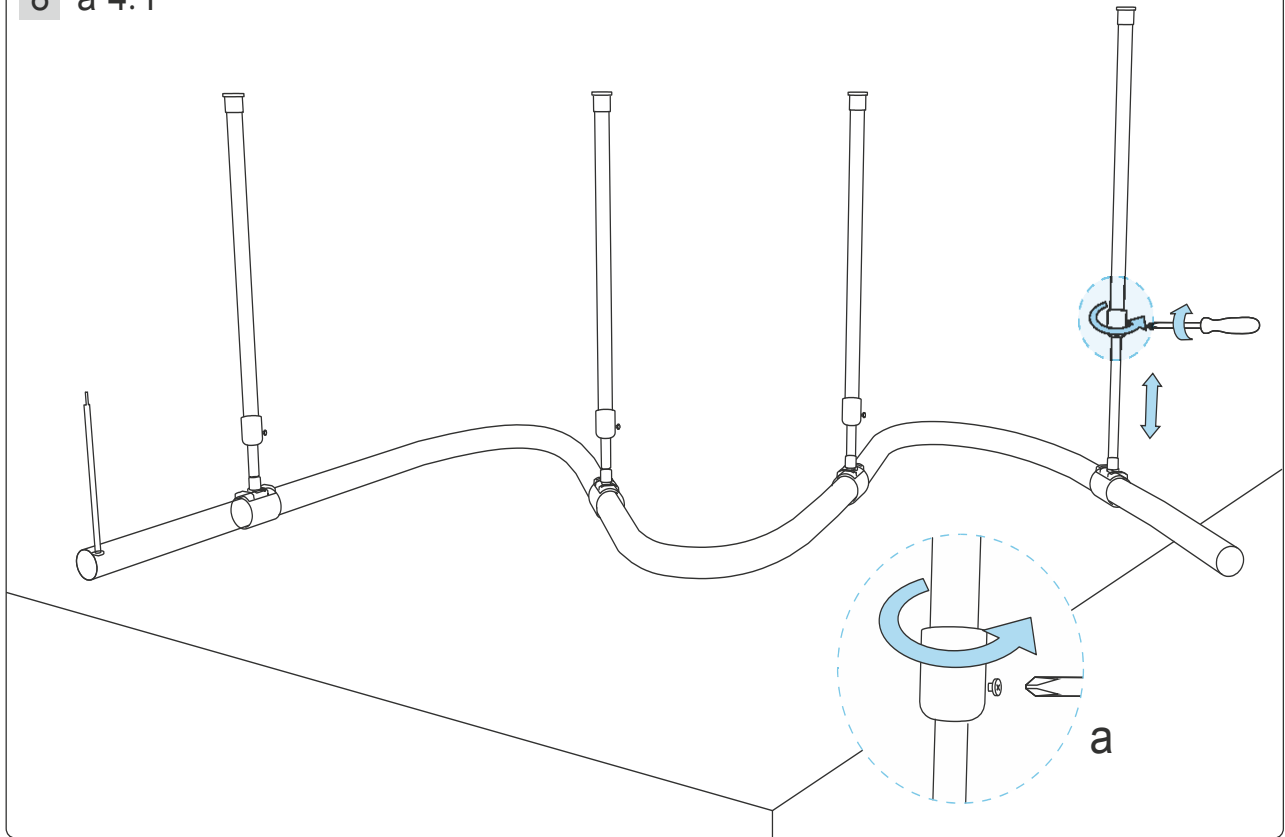

Installation for hanging one side or both side arrangement:

- Following items are needed for a one side or both side installation:
L6OP7A05 (one side) or L6OP7A06 (one side) or L6OP7A07 (both sides)

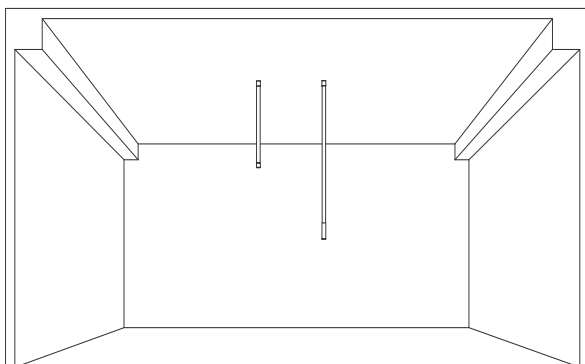

One side fixing

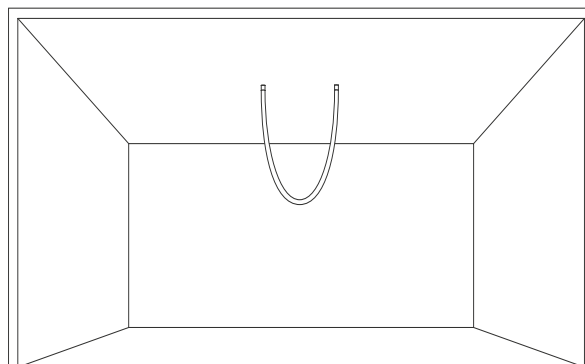

Both side fixing

2. Installation steps

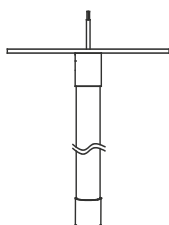

Straight

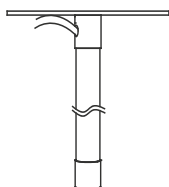

or side input

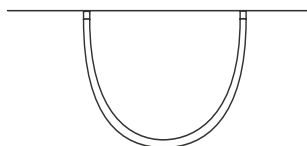

both side installation

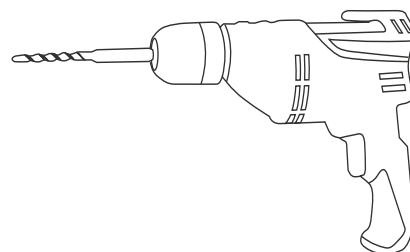

Drilling machine with drill Ø6 mm

Fixing at one side installation

1 a 2:1

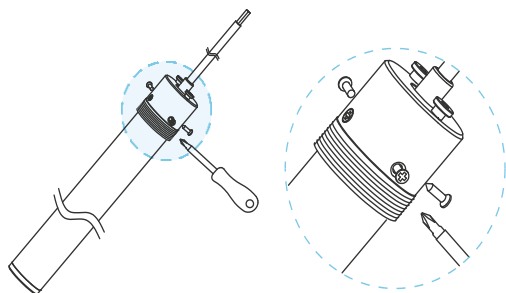

2

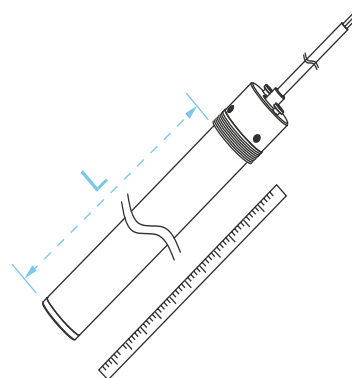

3

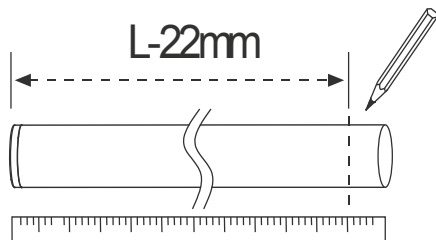
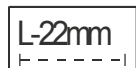

4

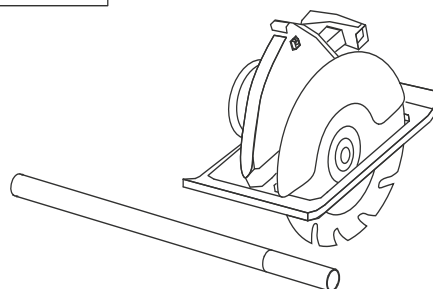
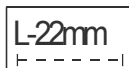

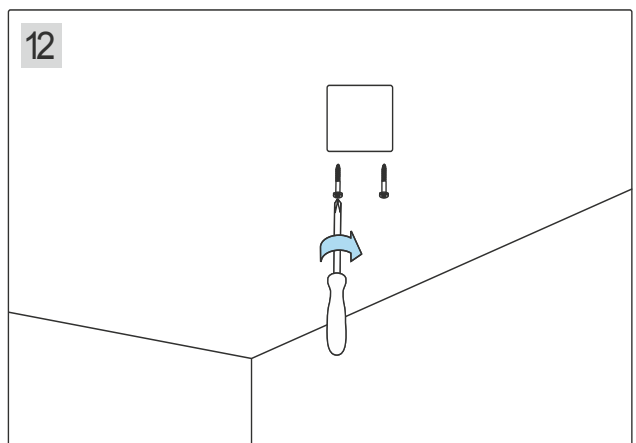
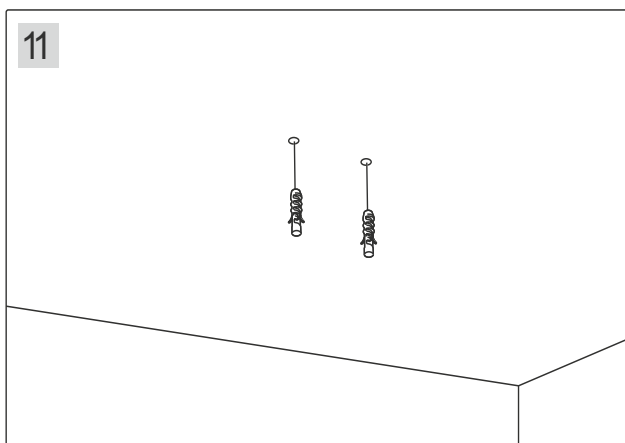
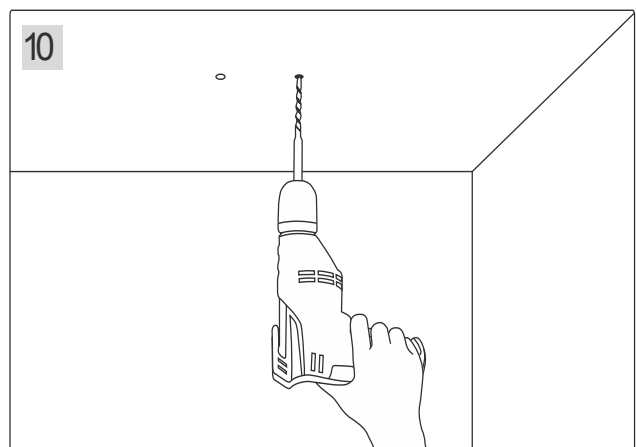
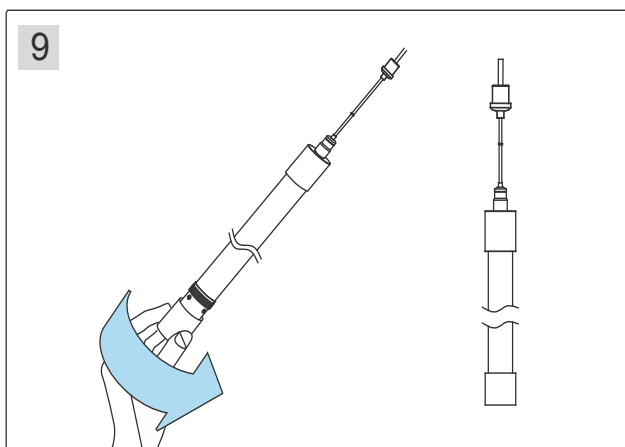
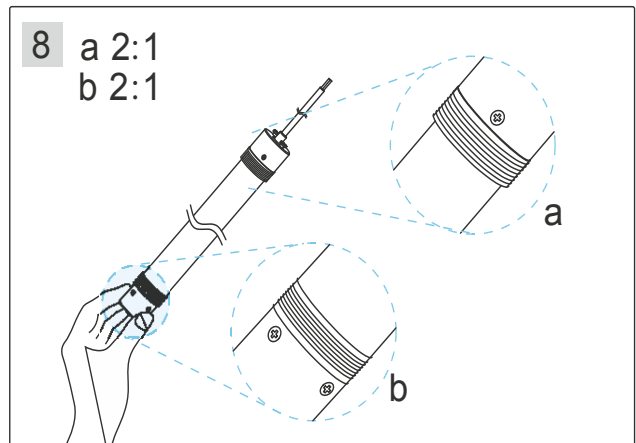
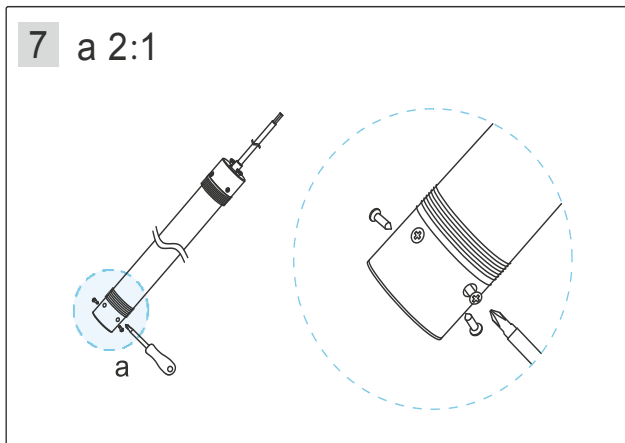
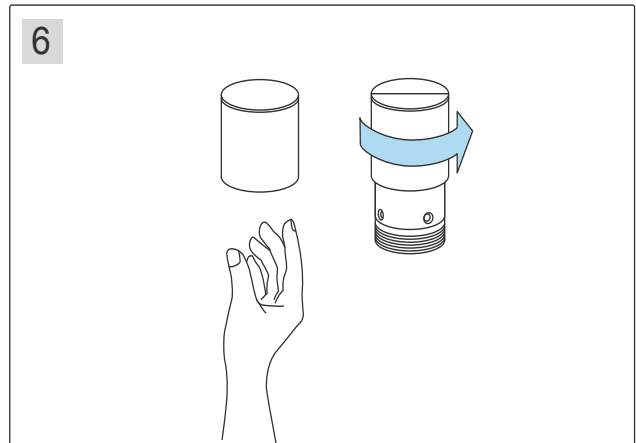
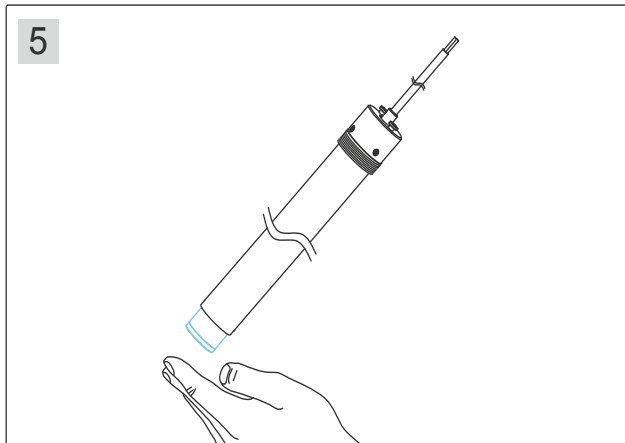

Fixed position

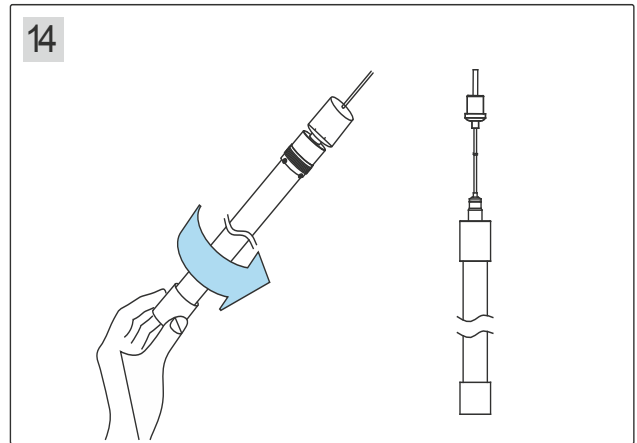
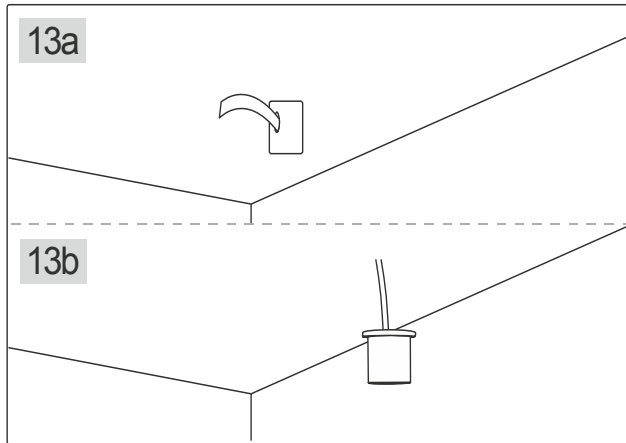

Concrete or suspended ceiling

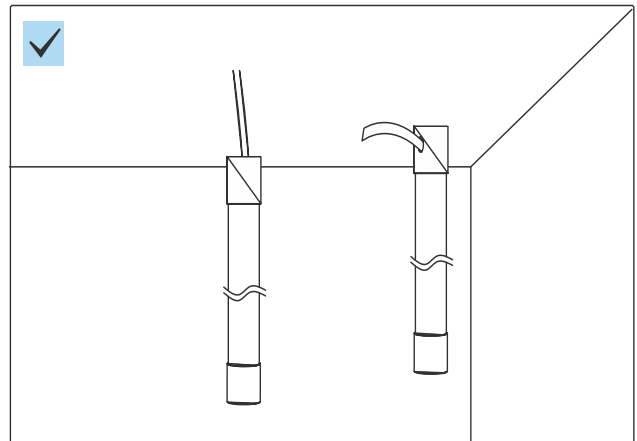
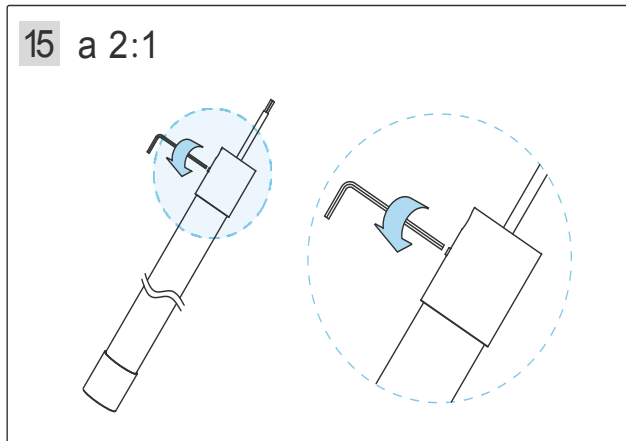

Fixing at two side installation

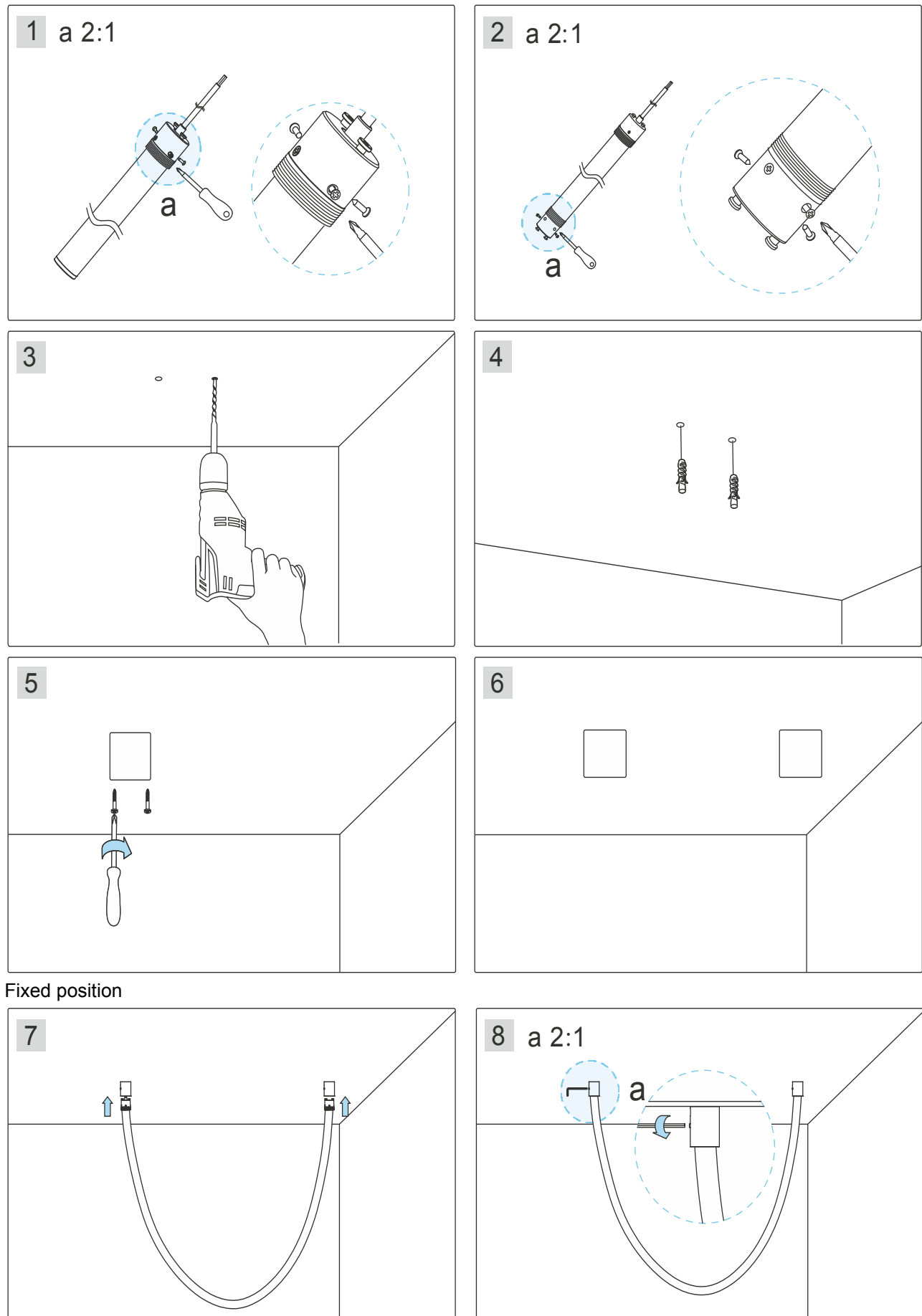

Fixed position

Installation for bended, under ceiling installation:

1. Following item is needed for a bended, under ceiling installation:
L6OP7A12

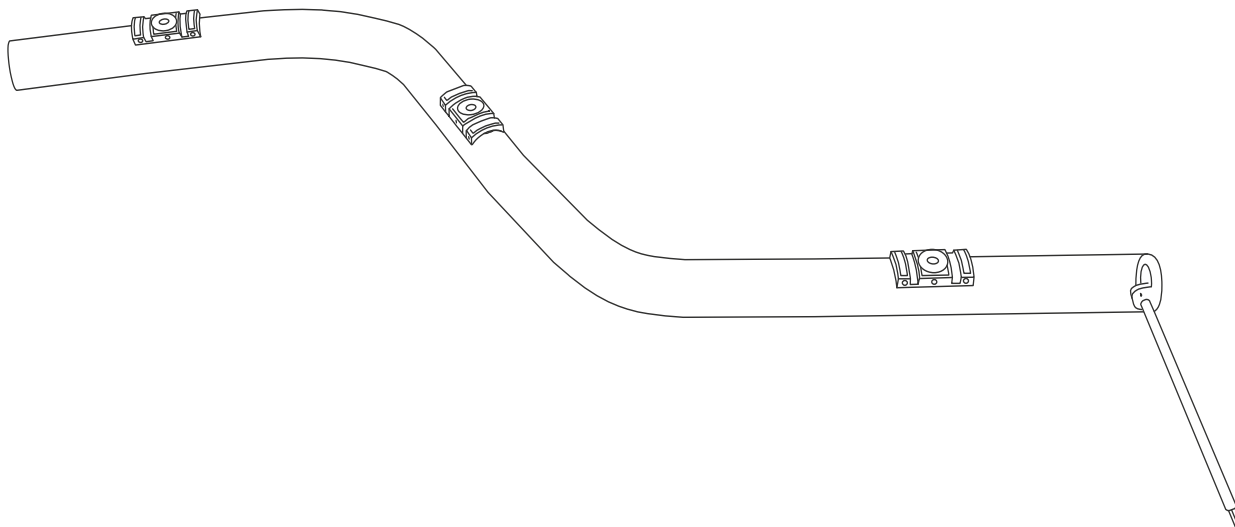

2. Installation steps

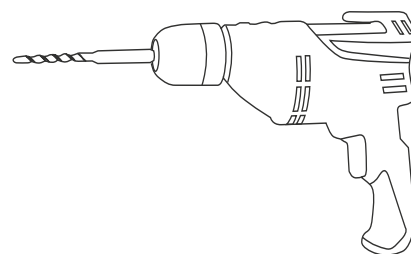
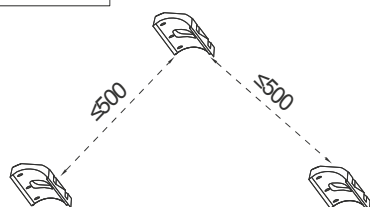

Drilling machine with drill $\varnothing 6\text{ mm}$

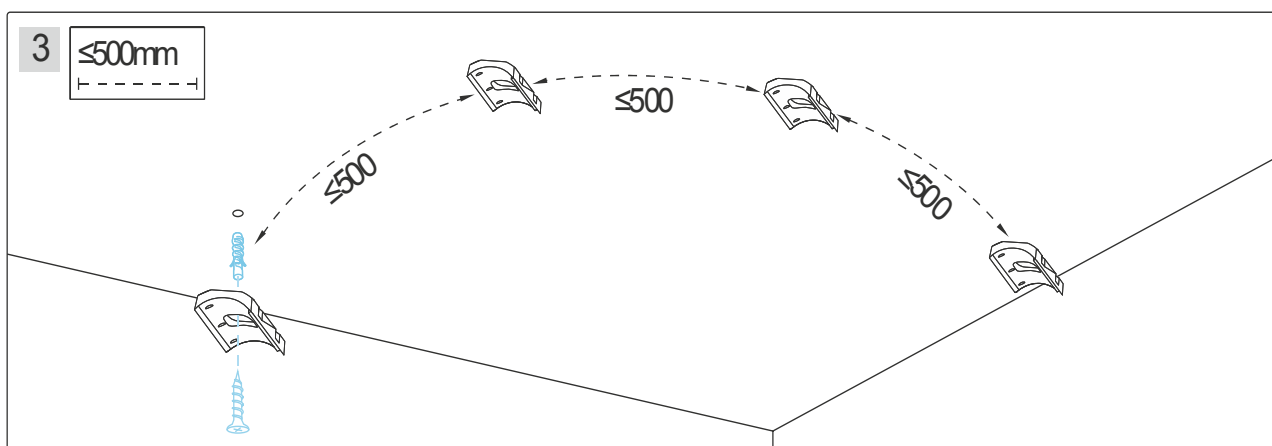
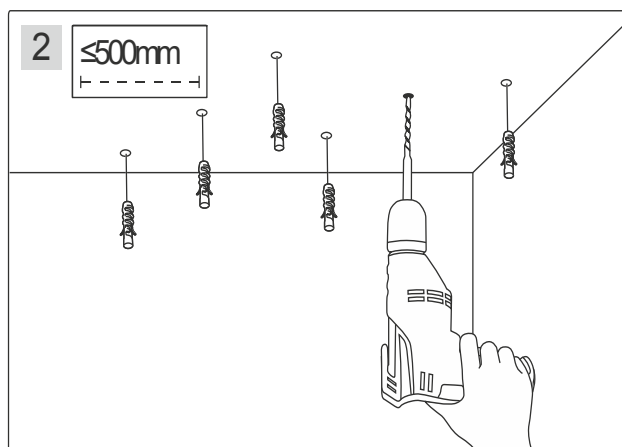
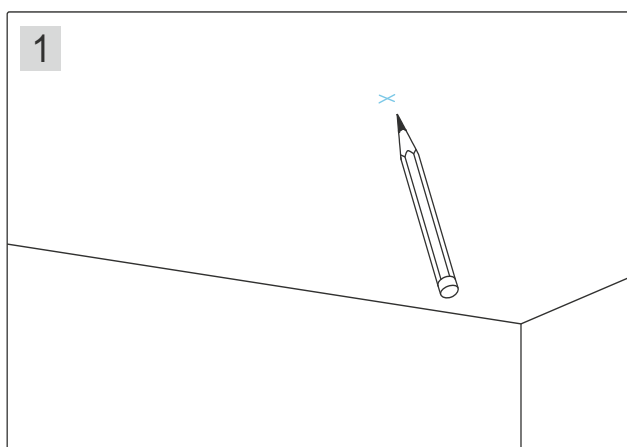

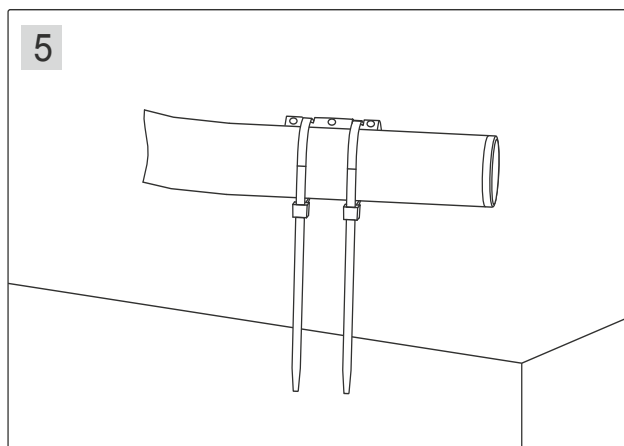
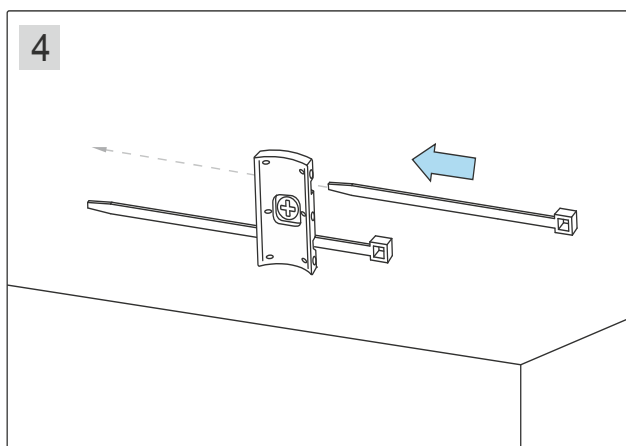

Fix the Flex Strip OPAL at the ceiling holder

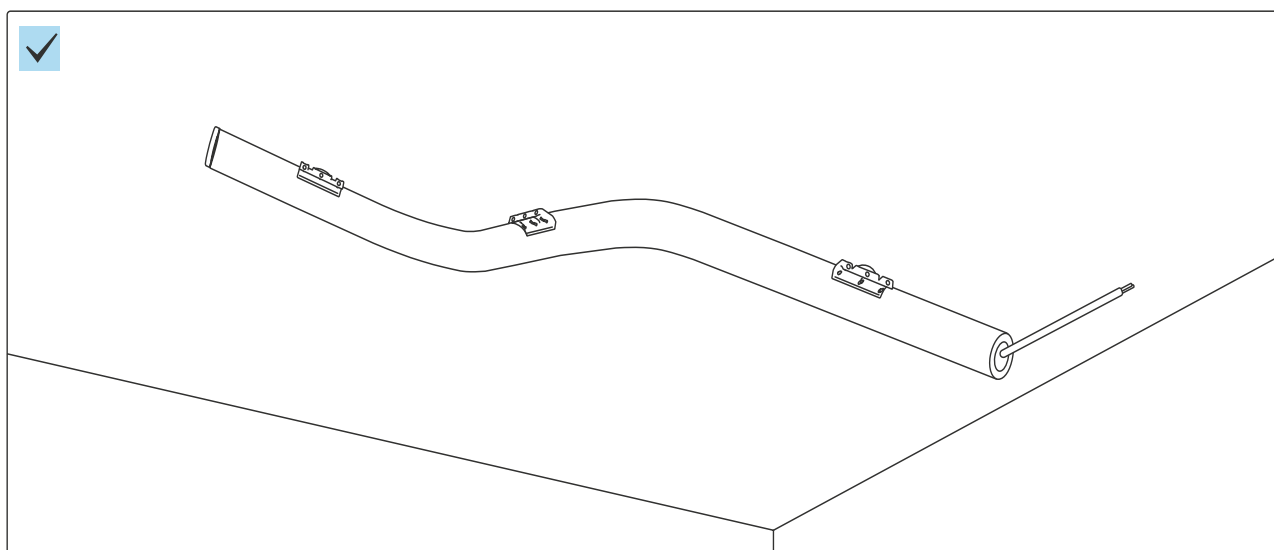
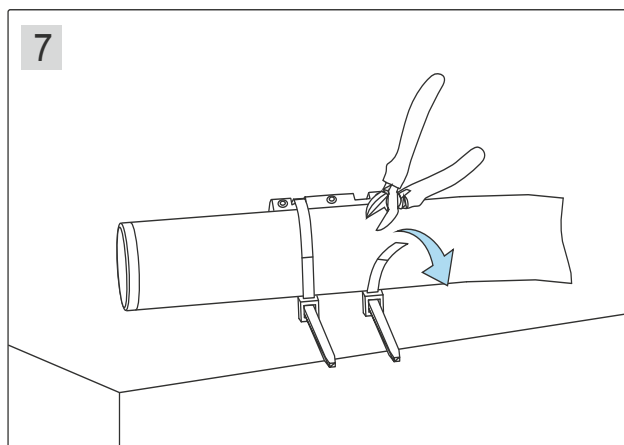
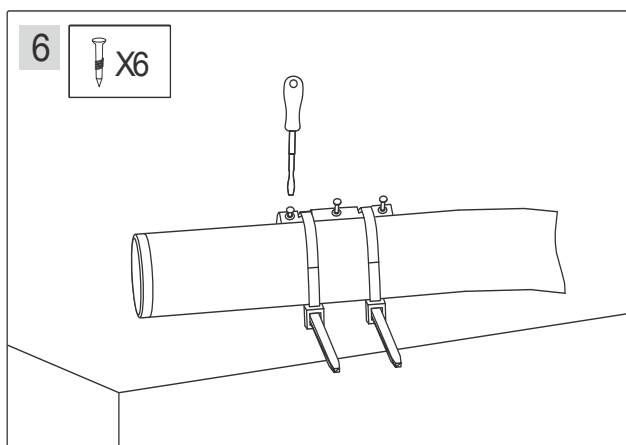

Installation for straight, under ceiling installation, length 1m:

1. Following item is needed for a straight, under ceiling installation:
L6OP7A09

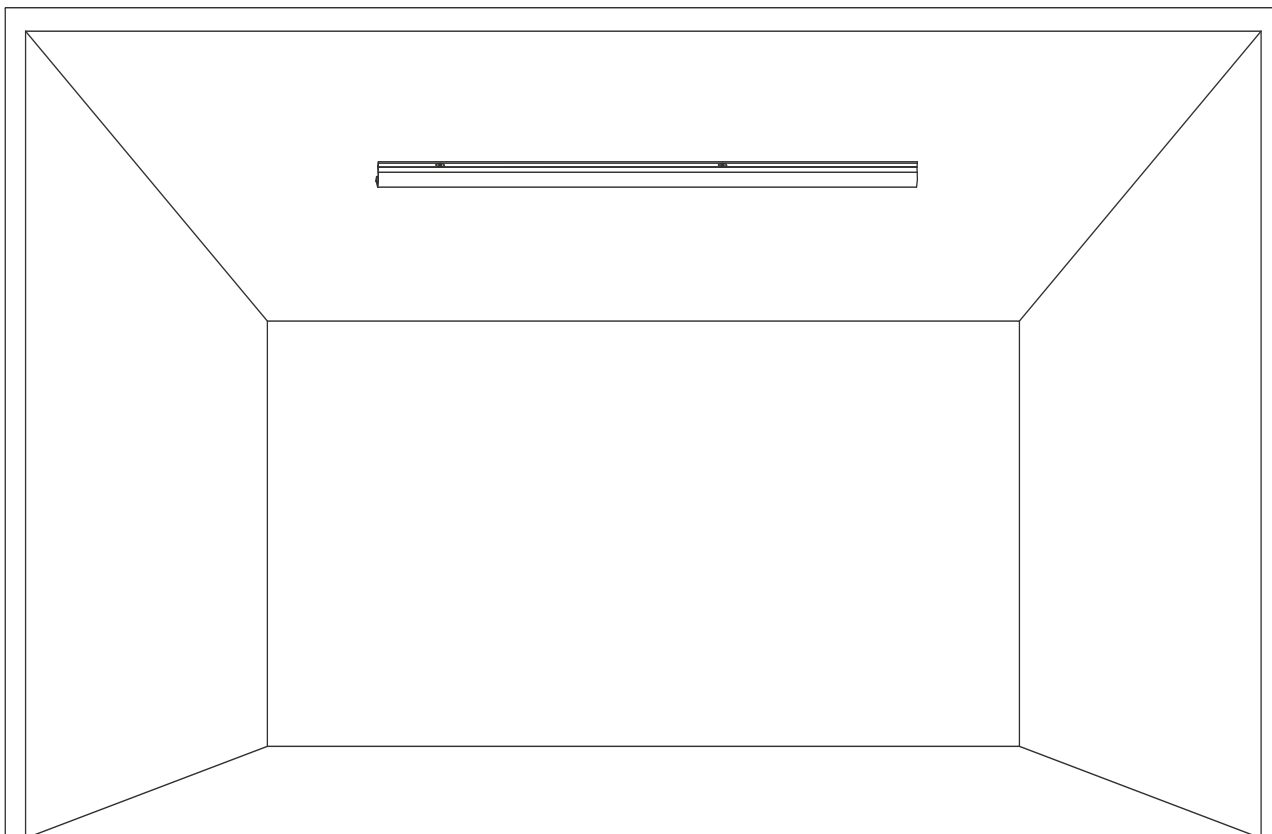
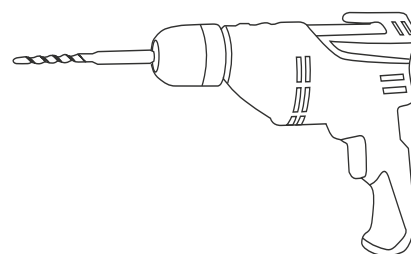
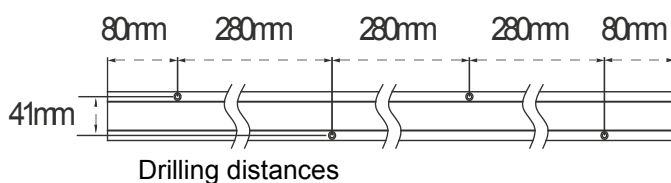
**2. Installation steps**

Drilling machine with drill Ø6 mm

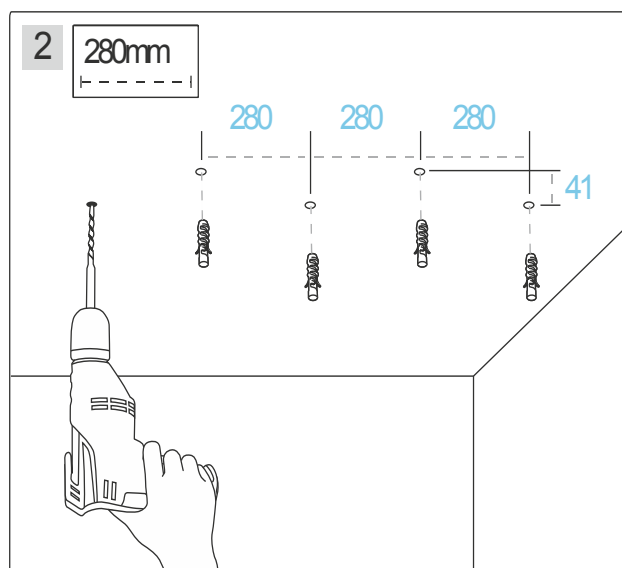
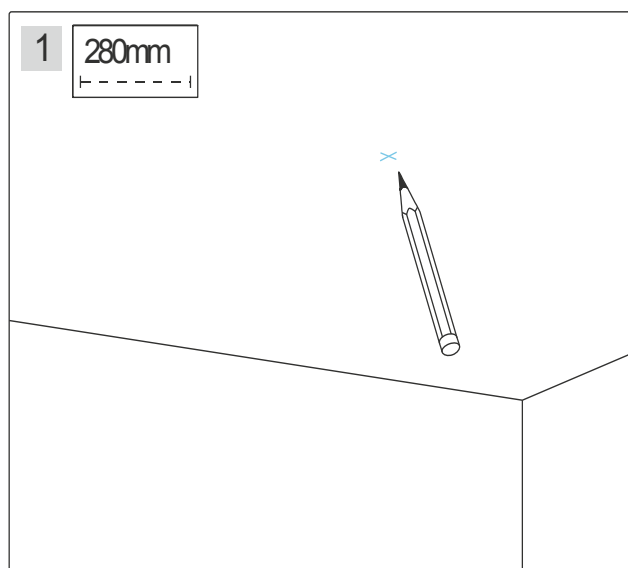

3

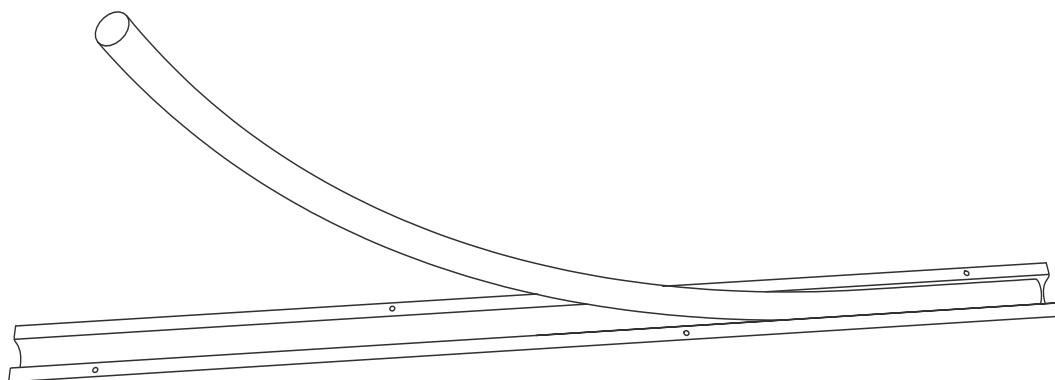

4

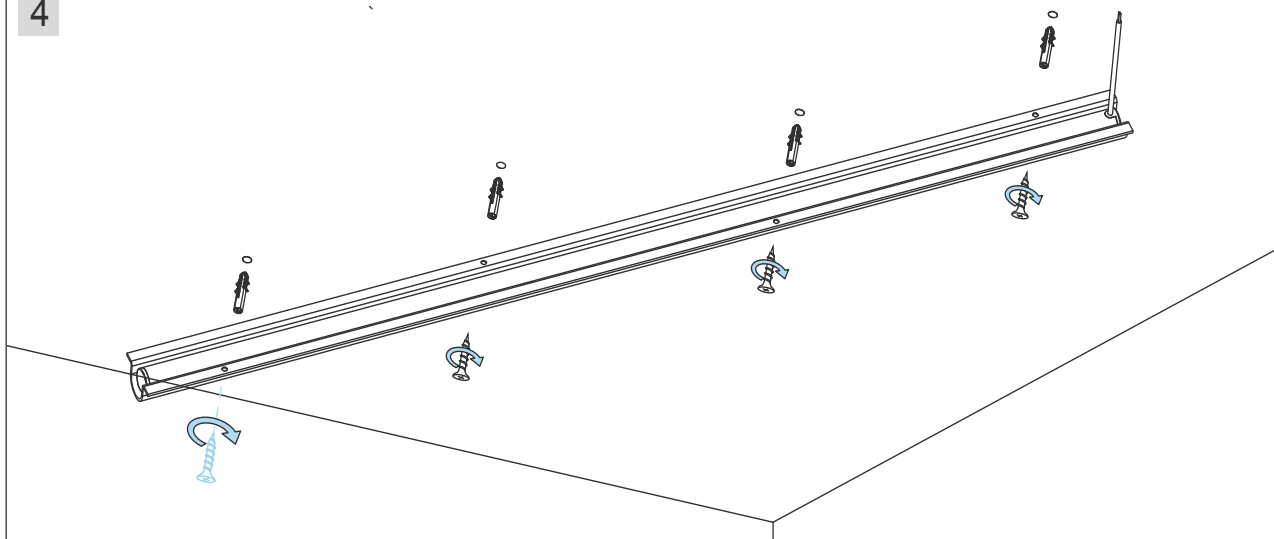

Installation for bended straight, suspended installation, length 1m:

- Following items are needed for a straight, suspended installation:
L6OP7A10 or L6OP7A11 and L6OP7A14

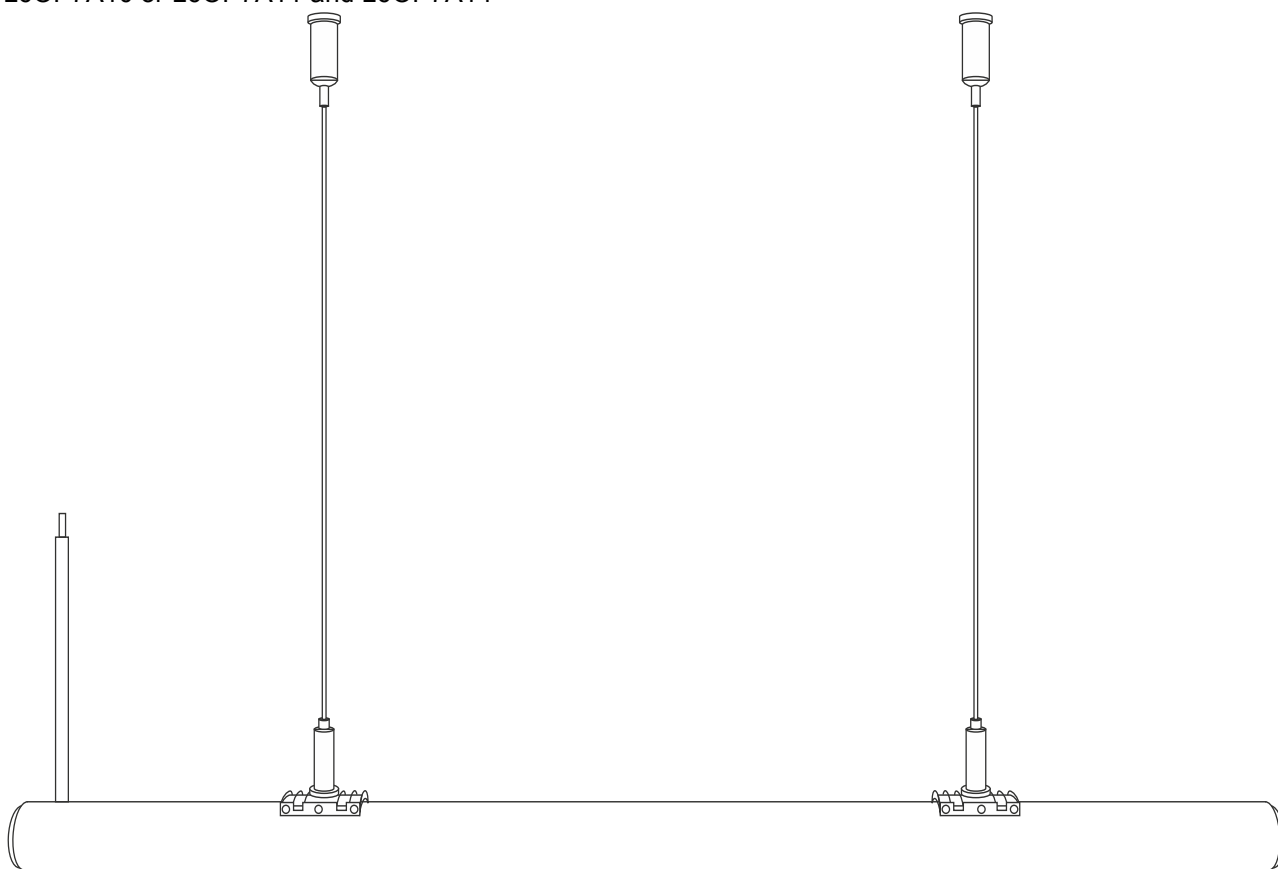

2. Installation steps

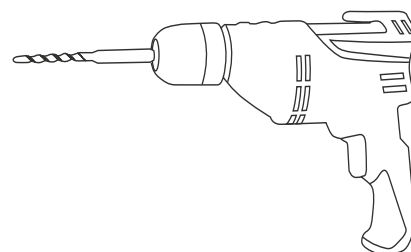
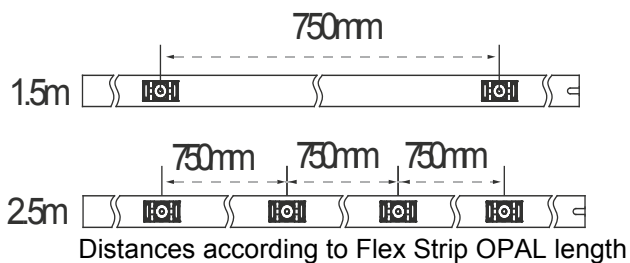

Drilling machine with drill Ø6 mm

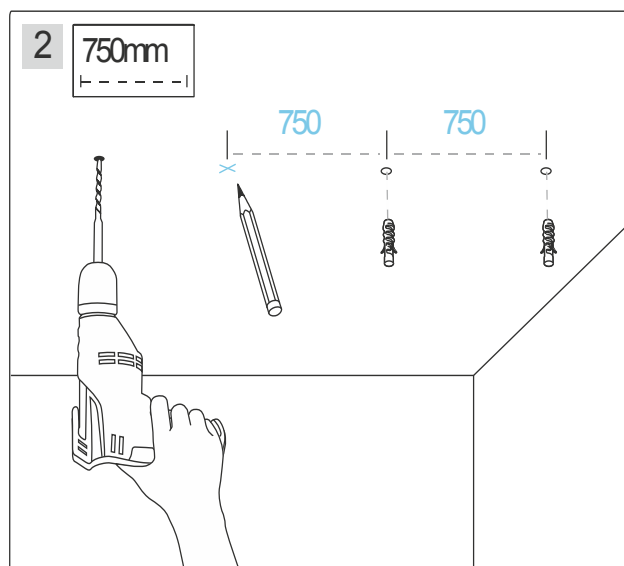
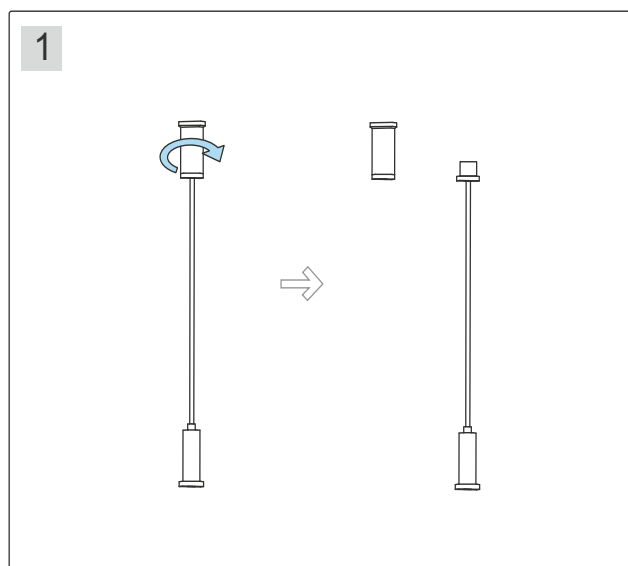

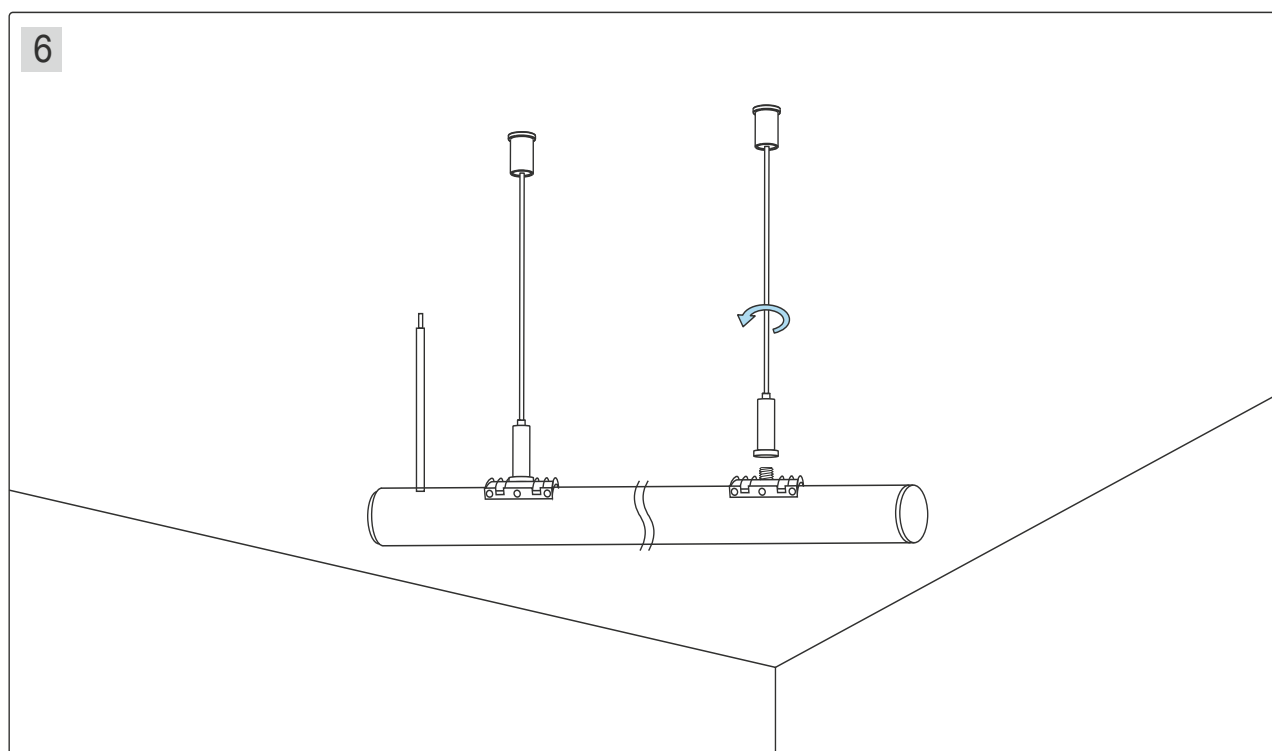
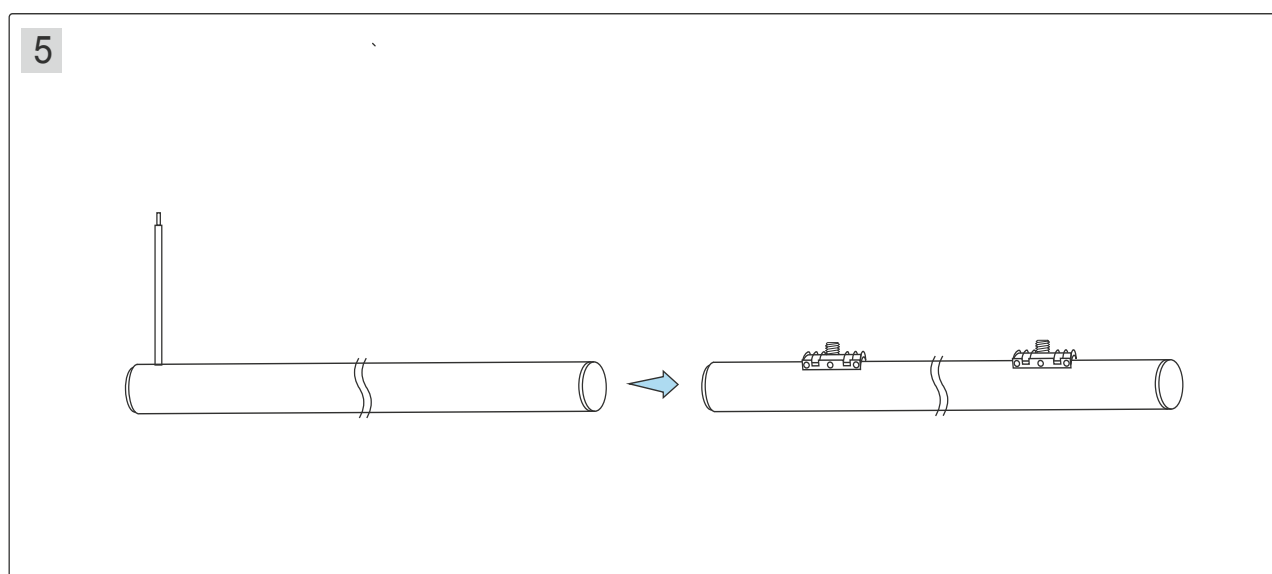
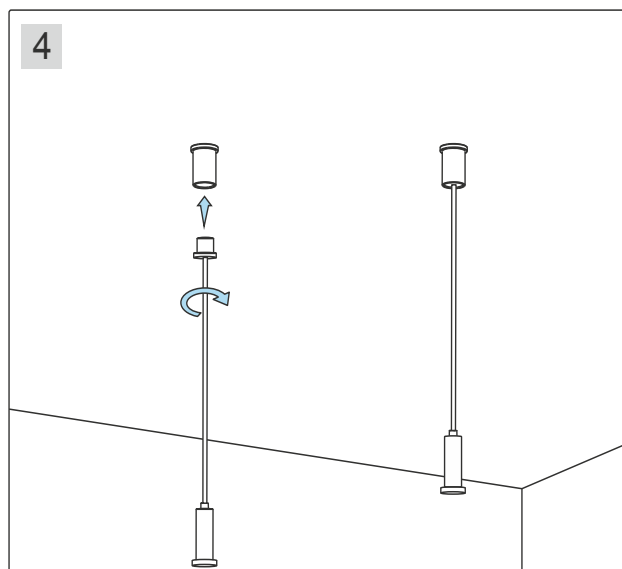
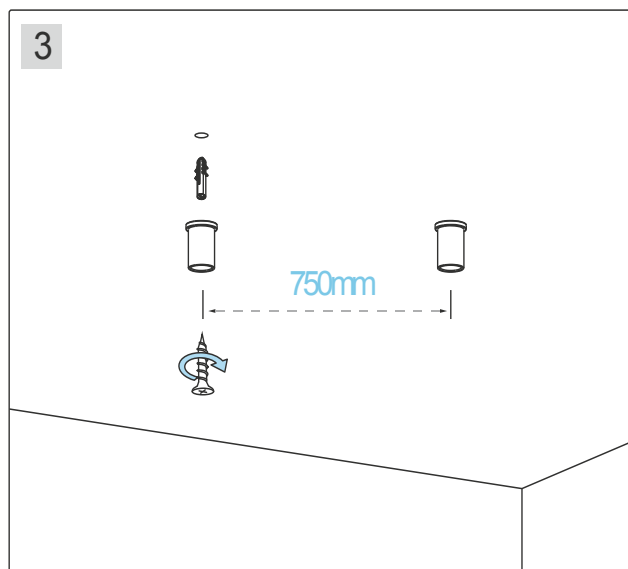

Installation of connectors:

1. Following item is needed for a connector:
L6OP7A08

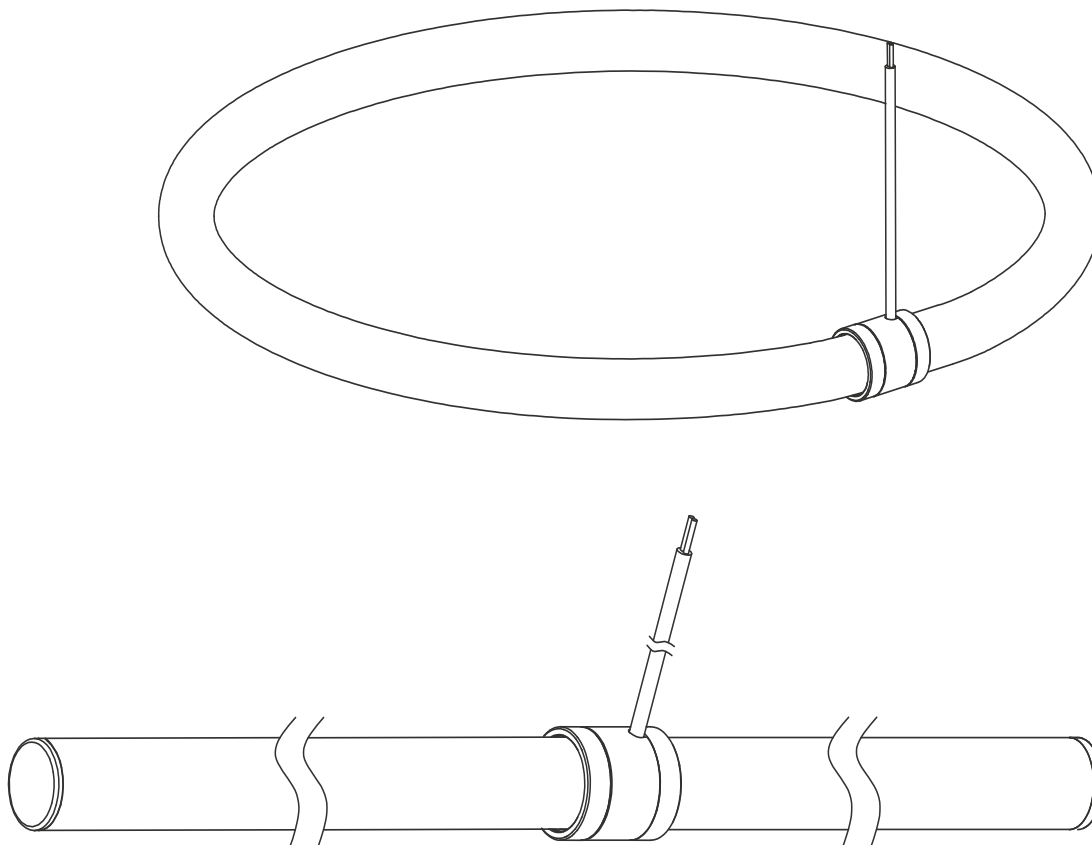
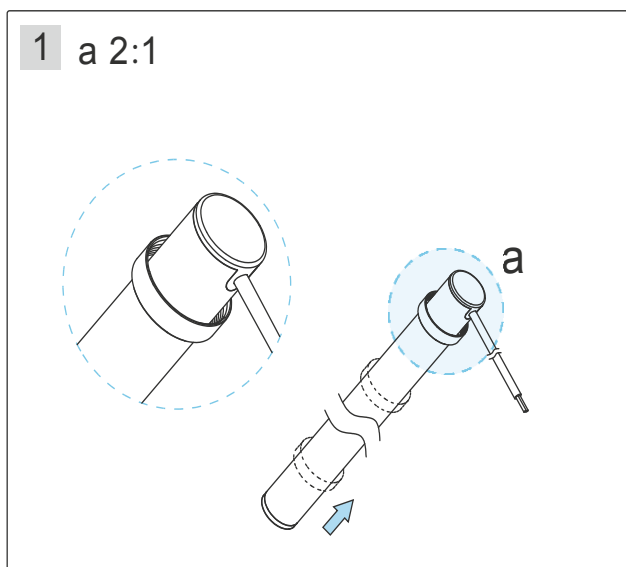
**2. Installation steps**

Put the connection ring on the Flex Strip OPAL

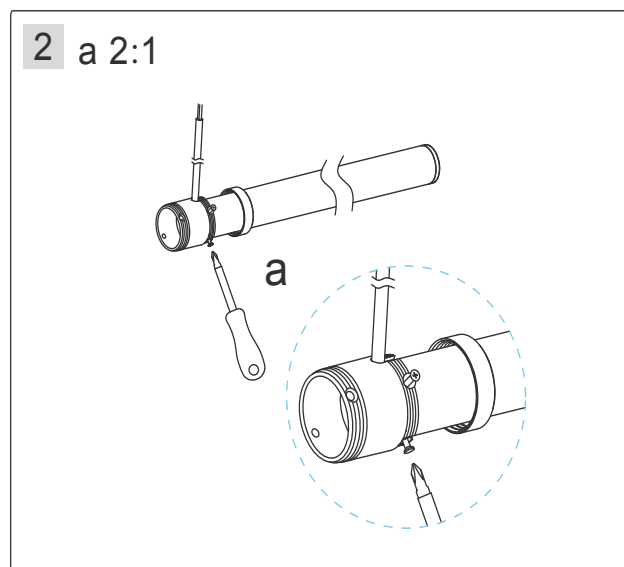

3

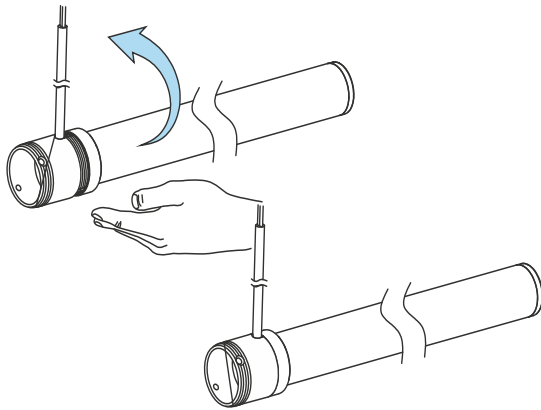

4 a 2:1

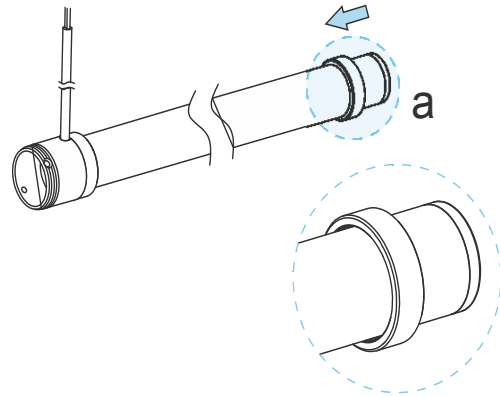

Move the connection ring back to the connector

5 a 3:1

